



# 8-inch 10-inch single docking station instruction

DC82 User manual



**IP SYSTEMES**

8 rue du Colonel Chambonnet – BP67

69672 BRON Cedex

Tel. : 04 72 14 18 00

Fax : 04 72 14 18 01

[www.ip-systemes.com](http://www.ip-systemes.com) – [info@ip-systemes.fr](mailto:info@ip-systemes.fr)

# Contents

I . Product Introduction .....	1
1. Appearance description .....	1
2. Indicator instruction .....	2
II. Instruction for use .....	2
1. Charge .....	2
2. Expansion interface .....	3
III. Specifications .....	4

# I . Product Introduction

## 1. Appearance description

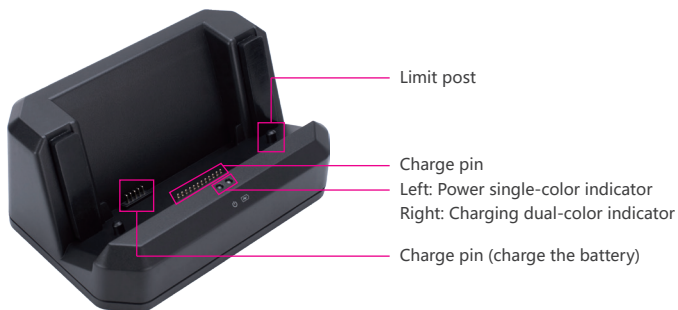

## 2. Indicator instruction

2.1 The DC82 docking has two kinds of indicator lights. The single-color power indicator lights up in blue, and the dual-color charging indicator lights up in red or green.

2.2 Docking power on, the blue indicator lights up. The indicator light won't change when the device is charging (always on).

2.3 Battery charging, the red light on. Battery fully charged, the green light on.

2.4 When the device and the battery are charged at the same time, the device is charged first. After fully charged the device, then charge the battery.

## II. Instruction for use

### 1. Charge

#### 1.1 Charge the device



## 2. Expansion interface

The back of docking station has three standard USB2.0 ports and one RJ45 network port. When connecting USB and network ports, the docking station must be powered (connected to DC), otherwise it cannot be used.



### III. Specifications

Chip	Charging IC	BQ24133 x1 (4.5~9V, 3A)
Interface	DC	5V/3A x1
	USB2.0	4pin x3
	RJ45	10/100/1000Mbps x1
indicator light	Status indicator	Power monochrome indicator: Blue x1
		Charging two color indicator: Red + Green x1
	mcu	RTL8152B-VB-CG

#### Remarks

Indicator definition:

1. Charging the whole machine does not need to look at the base indicator (look at the charging indicator of the machine itself)
2. When the base is powered on, the blue indicator light is on
3. The battery charging red light is on (all I16h batteries are put in to satisfy charging together) --- only I16h battery charging is supported
4. The battery is fully charged and the green light is on
5. The machine and battery are put into the base for charging, and the machine charging is preferred. After the machine is fully charged, the battery can be charged, otherwise the battery will not be charged.